



J M Adventure Ltd, Anvil Barn, Southcliffe Road, Swanage, Dorset, BH19 2JG,  
email: [info@jmadventure.com](mailto:info@jmadventure.com) website: [www.jmadventure.com](http://www.jmadventure.com) phone: +44 (0)1929 475691

---

## Aerial Trekking High Ropes Courses - Poles

Please see below various designs for J M Adventure Aerial Trekking High Ropes Courses on poles. Please note we are happy to custom design you a course to meet your training and commercial requirements, budget and for the ground space available. Courses can be designed to be built in phases to help with developing your course and spreading your budget.

### Safety Systems on the Courses

The two systems listed below offer continual safety for participants whilst traversing the courses. We have listed the advantages of both systems and detailed guide costs per element for the two systems. If you require an additional independent system for staff access or to increase participant capacity on the courses we are able to fit a dual system to operate in parallel with the one system. Many of our designs include both safety systems on varying levels to appeal to a broader audience.

#### **1. Niko Steel Track - Guide price per element - £6,800.00 + Vat**

- The track is a maintenance free option and does not require regular replacement parts as required with a wire system.
- The track allows participants to 'self rescue' or to be assisted by other participants as the track operates smoothly on the corners and does not sag as with a wire system. Additionally disabled participants (depending on the severity of their disability) can be hoisted on the rail and then traverse the course accompanied or by themselves.

#### **2. Continuous Wire System - Guide price per element - £6,500.00 + Vat Guide price - Additional dual level - £3,500.00 + Vat**

- The continuous Wire System allows the course route to gain and lose height and includes zip wires into nets and short zip wires between platforms.
- As the cable does not need a large steel structure to support itself the courses have less visual impact in sensitive areas.
- The Saferoller system does not cost as much as the Steel Track.

### Course Heights and Levels

For commercial courses the emphasis is high footfall. In our experience, our most successful designs have included multiple levels allowing participants to gain confidence on low level courses (3m - 6m Platform heights) and advance to the high level courses (9m - 12m Platform height).

Using the Saferoller Wire System the course can start at ground level and participants can gain height as they traverse the course.

### Course Layout & Design + Access & Egress

In order to reduce staff numbers and increase participant footfall we recommend an access tower as a hub for Aerial Trekking Courses. Access towers allow speedy unbelayed and unsupervised access and egress to various levels as well as being able to accommodate developmental / educational elements, Power Fan Descenders, Zip Wires and Climbing Walls.

A circular Aerial Trek Course means the participant can be despatched and met by the same member of staff before and after the course and that the hardware is ready in position for the next participants.



J M Adventure Ltd, Anvil Barn, Southcliffe Road, Swanage, Dorset, BH19 2JG,  
email: [info@jmadventure.com](mailto:info@jmadventure.com) website: [www.jmadventure.com](http://www.jmadventure.com) phone: +44 (0)1929 475691

## Aerial Trekking High Ropes Courses - Poles

An alternative to the access tower is to use any natural relief in the land (cliff edges and hill sides) to gain height to a start platform.

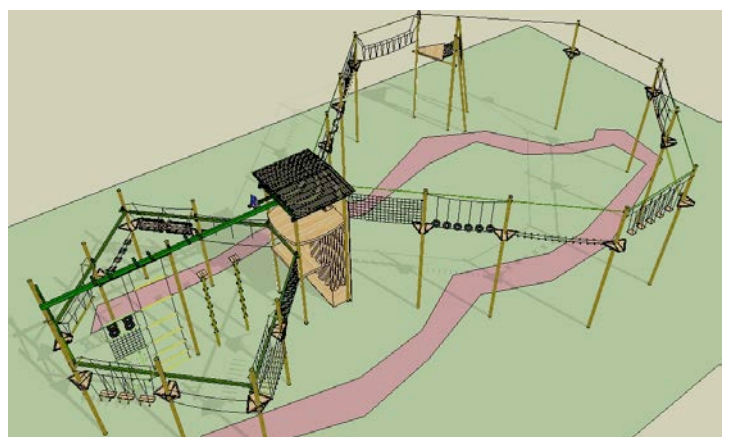
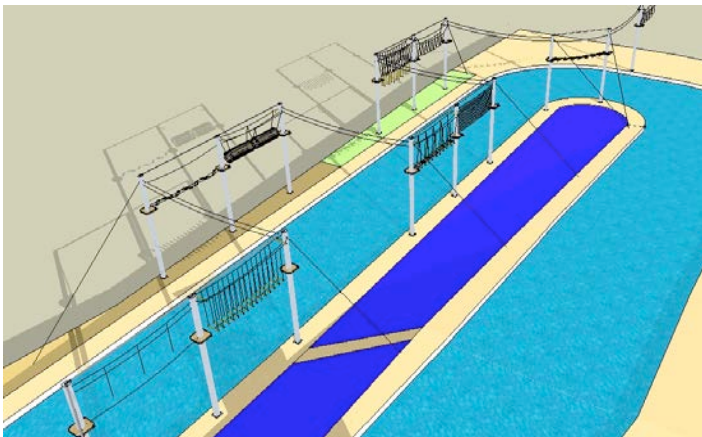
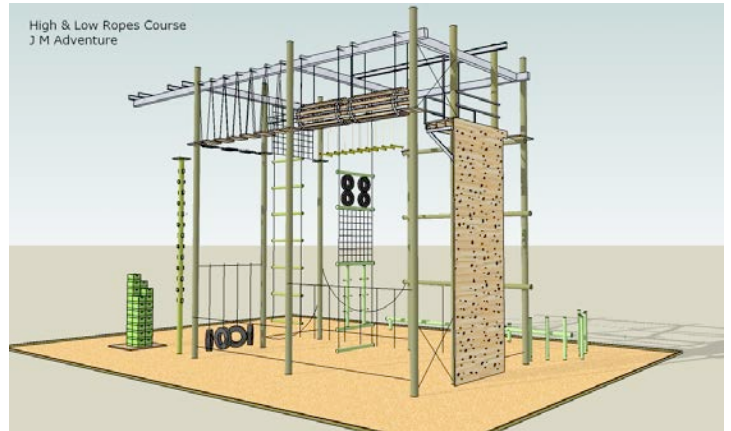
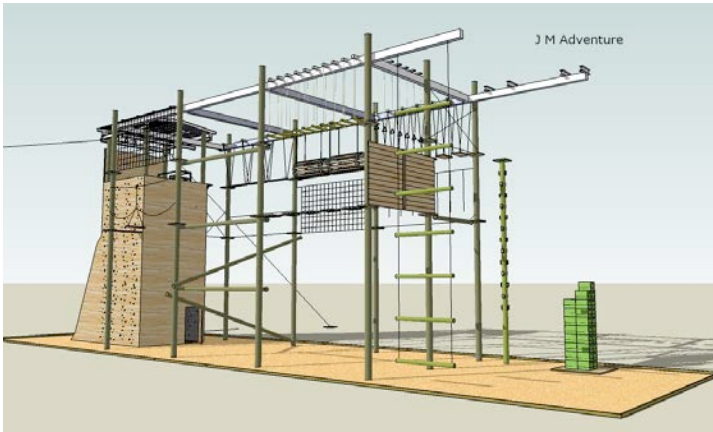





J M Adventure Ltd, Anvil Barn, Southcliffe Road, Swanage, Dorset, BH19 2JG,  
email: [info@jmadventure.com](mailto:info@jmadventure.com) website: [www.jmadventure.com](http://www.jmadventure.com) phone: +44 (0)1929 475691

## Aerial Trekking High Ropes Courses - Poles

London Zoo - High Ropes  
J M Adventure  
Concept with 2 x level



CTTE - Littledown Centre, Bournemouth  
J M Adventure  
Concept 1

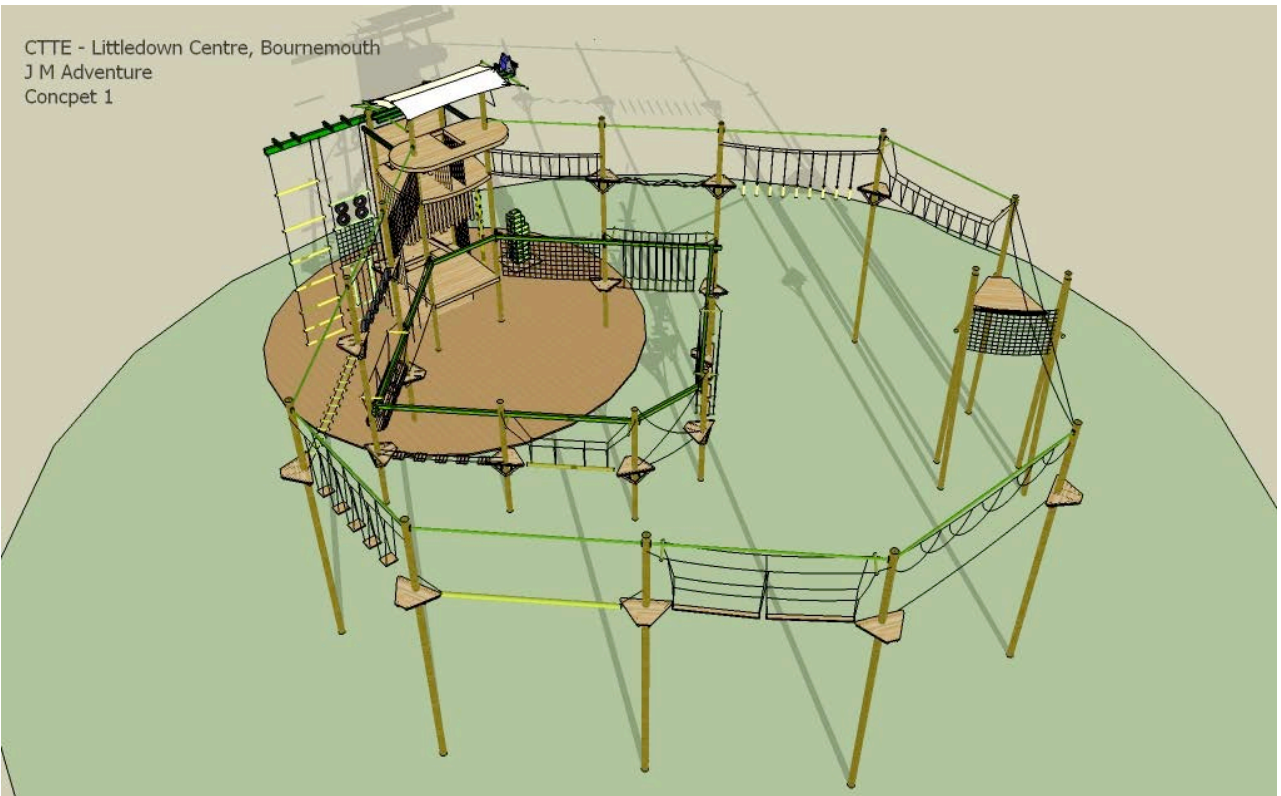



J M Adventure Ltd, Anvil Barn, Southcliffe Road, Swanage, Dorset, BH19 2JG,  
email: [info@jmadventure.com](mailto:info@jmadventure.com) website: [www.jmadventure.com](http://www.jmadventure.com) phone: +44 (0)1929 475691

---

## Aerial Trekking High Ropes Courses - Poles



### Standard Course Features

- Conforms to EN 15567-1 “safety requirements and test methods”
- Platforms on all poles
- Man riding continual Safety System allows access for all abilities and eases access for in house inspections
- Steel beams or CHS braces negate the need wire guys and braces, reducing the area required to build and secure the course.
- Five year warranty on all workmanship
- Vertical life lines for un-belayed in-house instructor access
- Safety signage to European Ropes Course Association (ERCA) standard
- Retractable or removable lower components to prevent unauthorized access
- 16mm combination hand ropes & Nets ensure longevity
- Trolleys - one per participant with two additional trolleys for instructor access
- Multiple levels for varying ability and exposure
- Painted steel to suit environment or galvanised steel to ensure longevity and reduce future maintenance requirements
- Treated, slow growing ‘select grade’ timber for the elements.
- Operating Procedures



J M Adventure Ltd, Anvil Barn, Southcliffe Road, Swanage, Dorset, BH19 2JG,  
email: [info@jmadventure.com](mailto:info@jmadventure.com) website: [www.jmadventure.com](http://www.jmadventure.com) phone: +44 (0)1929 475691

---

## Aerial Trekking High Ropes Courses - Poles

### Optional Extras

- Double Safety System
- Manual All Ability / Disabled Winch
- Lightening Conductors

### Additional Elements and Integrated Developmental Elements

- Power Fan Descender
- Multiple areas of aerial trekking
- Zip Wire
- Gladiator Challenge - Four Person
- High See Saw - Four Person
- Six Person High All Aboard
- High All Aboard - Four Person
- Leap of Faith - Two Person
- Jacobs Ladder - Four Person
- Triple Balance Beams - Up to Two Person
- Walk the Plank Leap of Faith - One Person
- Climbing and Abseil walls or Abseil Platforms
- Gorge Crossing / Tyrolean Traverse Exercise / High Slack Line
- Low Ropes Course fitted to the base of the poles

### Dimensions

- Height Between 8m and 15m.
- Length & Width Courses are designed to fit your site
- Pole Depth 2m
- Ground Space required Courses are designed to fit your site
- Build Time Dependant on the course and access to your site

### Extra Costs for Consideration

- Personal Protective Equipment (PPE). Please contact us for a competitive quote for your PPE requirements. Please note that the **HSE working at height regulations** require staff to use access full body harnesses for in-house inspections and maintenance conforming to EN795.
- Accommodation for Construction Technicians whilst on site if this cannot be supplied by the client
- Mileage to and from site - 50p per mile x 2 work vehicles
- Flights, airport parking, connections and ferry costs were applicable
- Inaugural Inspection - Optional - Recommended - European Ropes Course Association (ERCA) - See Below
- Annual Inspection costs
- Ground Preparation and Covering - See Below
- Site Specific Training - See Below
- Fencing, footpaths and landscaping
- Planning application fees



**J M Adventure Ltd**, Anvil Barn, Southcliffe Road, Swanage, Dorset, BH19 2JG,  
email: [info@jmadventure.com](mailto:info@jmadventure.com) website: [www.jmadventure.com](http://www.jmadventure.com) phone: +44 (0)1929 475691

---

## **Aerial Trekking High Ropes Courses - Poles**

- Insurance
- Client held contingency sum - construction phase

### **Ground Cover & Surrounds**

We use pea gravel as it has good drainage and does not mulch down and require topping up like bark chip and wood chips. If you would prefer wood or bark chip we can supply it. The covering is 150mm deep as a minimum, laid on a geotextile membrane to prevent foliage growing through and enclosed in a treated timber surround. We can also supply rubber safety matting surfaces

### **Site Specific Training**

Staff will be trained, assessed and certified by Vertex Training, a professional and established ropes course training company. Training will include operational procedures for the ropes course, correct use of PPE, access, inspections and rescues, challenge by choice and development skills. The duration of the training course will depend on the experience of the staff using the course. Training programmes accommodate up to ten members of staff to attend a site-specific training course. The daily training rate is £400.00 + Vat per day excluding mileage at £0.45 per mile and accommodation costs

### **ERCA Type A Inaugural Inspection - Optional - Recommended**

To ensure your new course complies with European Ropes Course Association (ERCA) standards, EN 15567-1 “safety requirements and test methods” and EN 15567-2 “operational requirements” the structure and supporting paper work needs to be independently checked by a Part A ERCA inspector. The course will need to be inspected on completion of the construction phase.

All information subject to change without notice and correct as of March 2015